

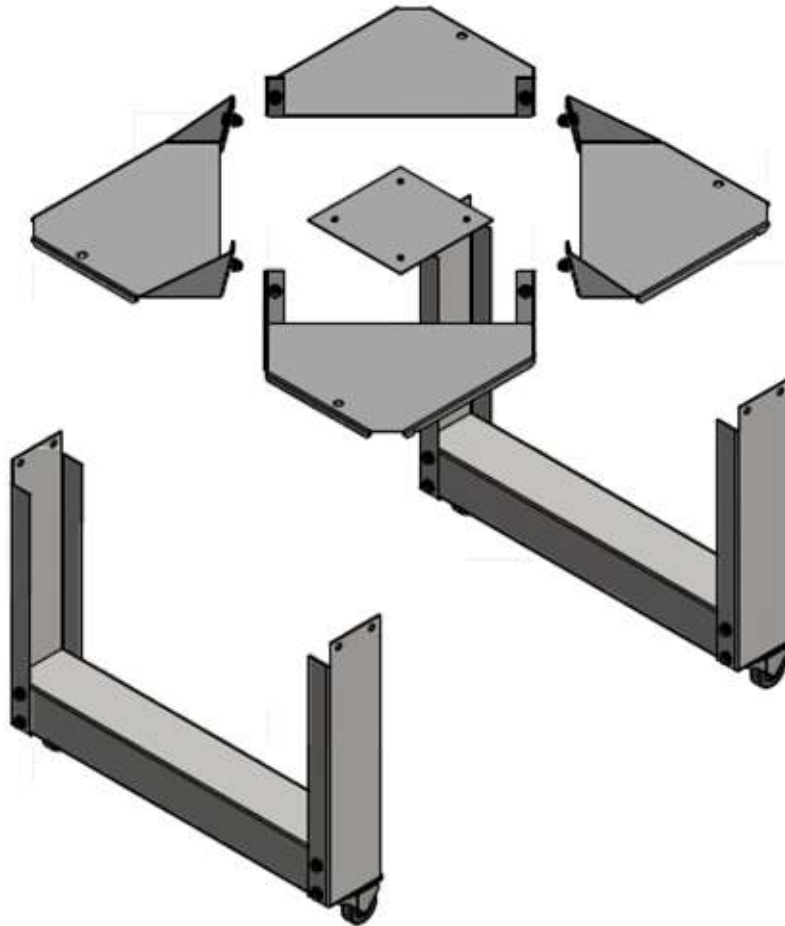

# ASSEMBLY INSTRUCTION

## XPD LEG KIT

*(Original Document)*



**IMPORTANT INSTRUCTIONS**  
**SAVE THESE INSTRUCTIONS FOR FUTURE REFERENCE**

800-654-4205 – 1100 Jefferson Street – Pacific, MO 63069 USA

[www.bbcind.com](http://www.bbcind.com)

## Assembly:

ENSURE ALL PARTS ARE ENCLOSED:

ITEM	QTY	DESCRIPTION
1	4	CASTER ASSEMBLY
2	4	CONVEYOR LEG
3	2	CROSS MEMBER FOR LEGS
4	38	5/16-18 x 3/4L BOLTS
5	1	VENT COVER
6	4	SCREW #6 x 3/8L
7	2	PRESS MOUNTING BRACKET
8	2	PRESS MOUNTING BRACKET
9	2	NUT 5/16-18

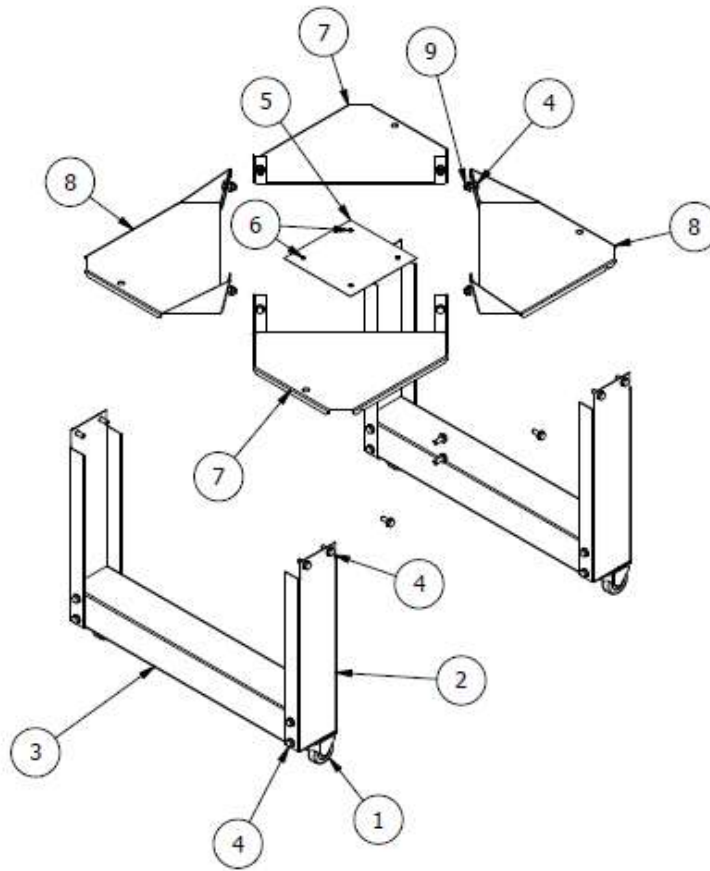

1. Assemble Little Buddy Conveyor Dryer per its User Manual. The **LB21-LK** box and its components are replaced by the **LB21-XPD-120** or **LB21-XPD-240** that shipped with your Dryer.
2. Remove **EXHAUST START COLLAR** from top of **HEATING CHAMBER**.
3. Install **VENT COVER [5]** using four **SCREWS #6 x 3/8L [6]**.
4. Assemble your Screen Print Press per its User Manual. Use the two different **PRESS MOUNTING BRANCKETS** in leu of the Press Legs.  
Note: Mount the brackets on the Base of the Press to achieve the desired orientation on the Dryer.
5. Set base with brackets on top of chamber.